

Quelques croquis



sol plufond 2,50
les cotés: $\frac{2,50}{2}$ ou 2m

sol. $\begin{cases} 2 \times 2,50 \text{ m} \\ 2 \times 2 \text{ m} \end{cases}$

Poteau max.
 $4 \times 2,50 \text{ m}$

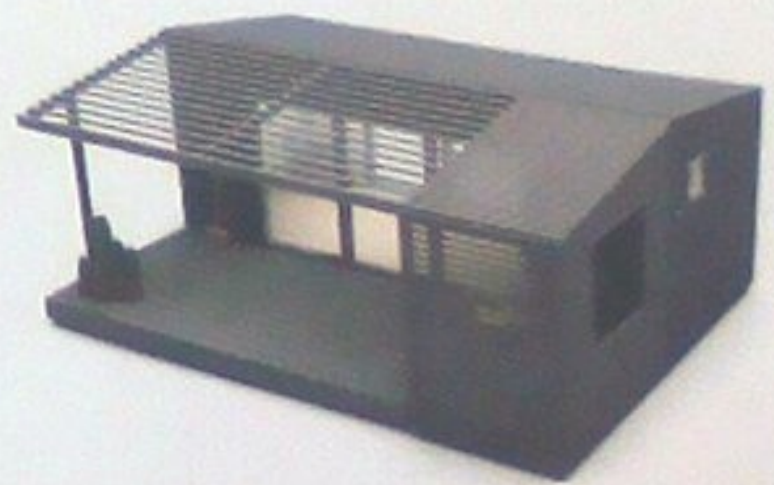

Léna Howard
Chloé mandre

Etage $\leq 1,80$ m
 hauteur: $2,50$ m

Echelle de croquis
 $50\text{m} \rightarrow 1\text{cm}$

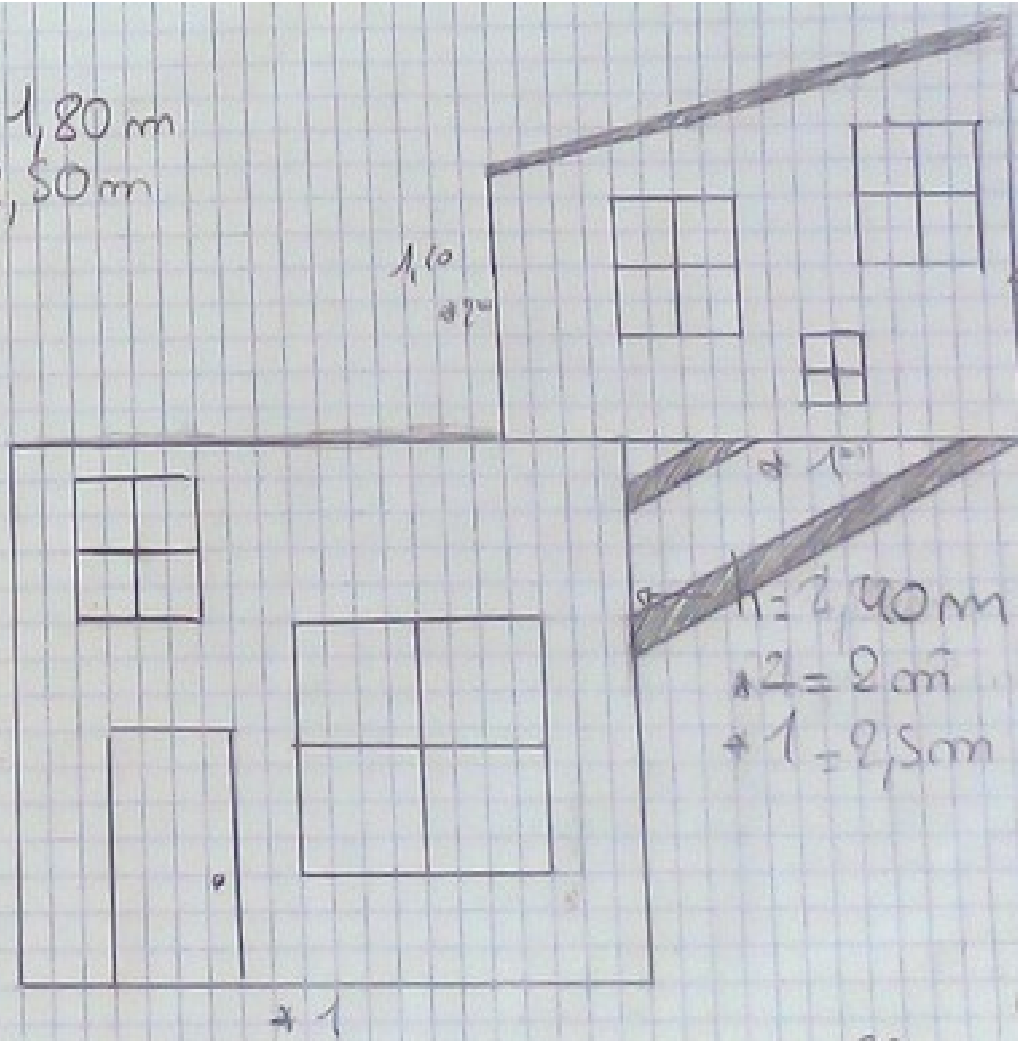

1,10
 +2^m

$h = -1,80$ m
 +2^m = 2 m } environ
 +1^m = 2,5 m

$h = 2,40$ m
 +2 = 2 m
 +1 = 2,5 m

+2

+1

YLL

CUNARD

ceva OK



2 x 2 m
 2 x 2,5 m

4 x 2,5 m